

Instructions for installing CT4-2000 Summer Cover on units built after 3/15/04

1. Remove valve cover, top with drinkwells, and floating closures.
2. Mount bracket on tower of base with 3/8 x 1 1/2 " bolts, nuts and washers provided.
3. Place summer cover on base over mounting bracket. Place 3/8" x 1 1/2" flat washer over mounting stud and install 3/8" hex nut and tighten.

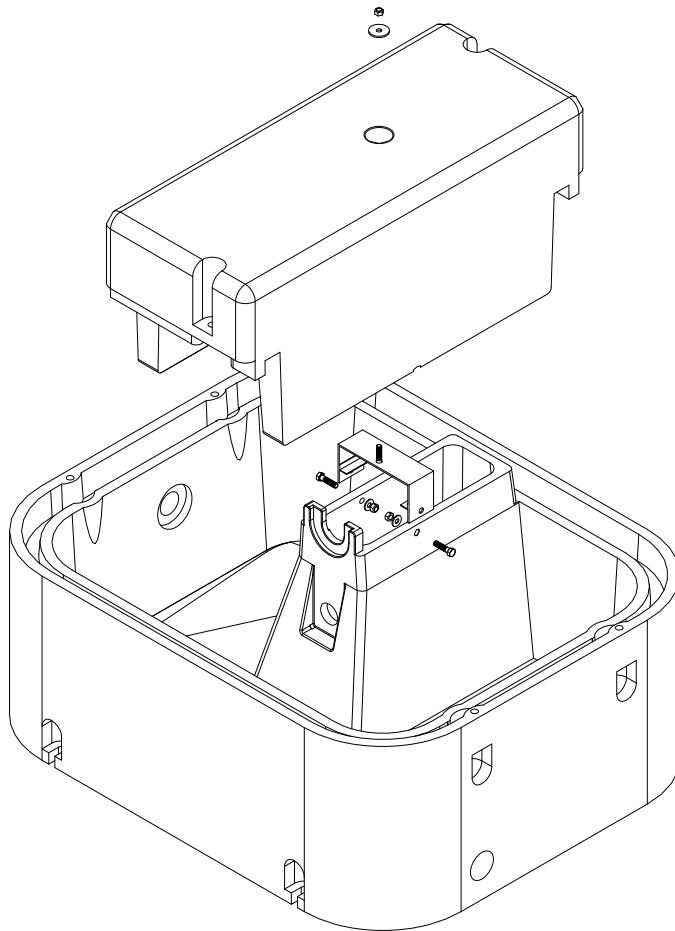

Instructions for installing CT4-2000 Summer Cover on units built before 3/14/04

1. Remove valve cover, top with drinkwells, and floating closures
2. Locate mounting bracket as shown in drawing below. Drill (2) 13/32" diameter holes through the hole in the bracket into the center of the access tower.

Note: use silicone sealant (caulk) to seal holes drilled in base. This will prevent moisture from migrating into insulation.

3. Mount bracket onto tower of base with 3/8 x 1 1/2 bolts, nuts and 7/8" diameter washers provided. As shown on opposite side of instruction sheet. Tighten nuts.
4. Place summer cover on base over mounting bracket. Place 3/8 x 1 1/2 washer over mounting stud, install 3/8" hex nut and tighten.

